

Southview Industrial Park Shell Building

1020 Westview Drive, Iowa Falls, Iowa



24,000 sq. ft.
150' x 160'
24' Sidewalls



View video at www.iowafallsdevelopment.com

- 1 16' Overhead Door
- 2 Dock Doors
- 4 Minutes to U.S. 20 (4 Lane)
- 15 Minutes to I-35
- Expandable
- Water: 2" Service and 6" Fire Service
- Sewer: 8" Sanitary Line; 18" Storm
- Electric: Three Phase; 7200/12500

iowafallsdevelopment.com

641-373-3455

director@iowafallsdevelopment.com

Southview Industrial Park

1020 Westview Drive, Iowa Falls, Iowa

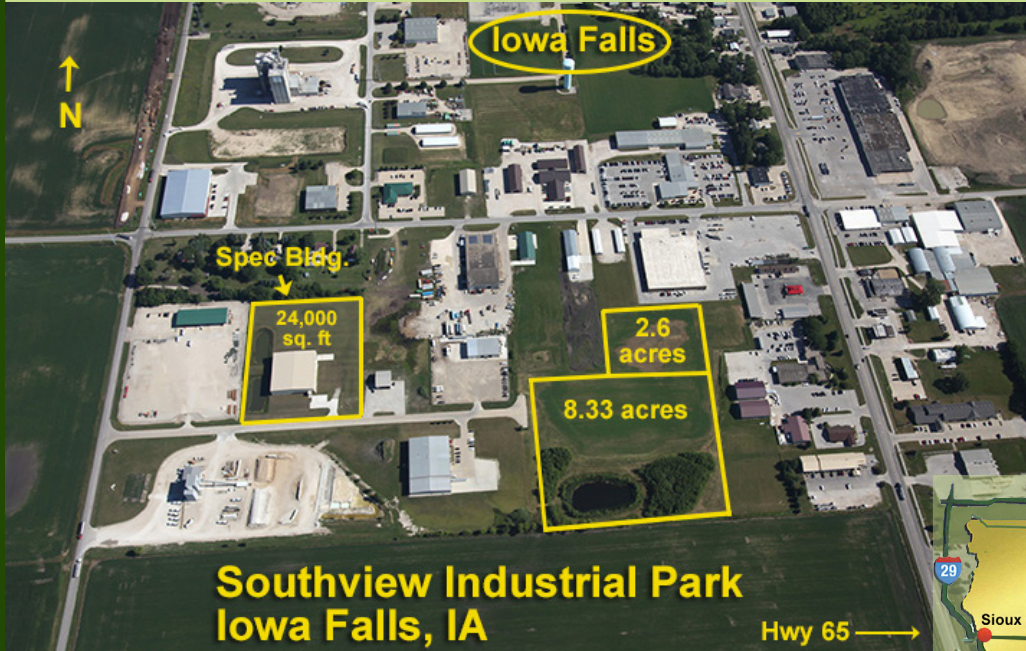

Southview Industrial Park Iowa Falls, IA

Hwy 65 →



Mark Buschkamp
Iowa Falls Area Development Corporation
641-373-3455
director @iowafallsdevelopment.com
www.iowafallsdevelopment.com

Other Local Businesses

- Agri-Pro Enterprises
- Cam Spray
- Campbell Supply
- Cargill
- Ellsworth Community College
- Flint Hills Resources
- Forterra
- Iowa Power Supply
- Metal Tech Industries
- Natural Recycled Protein
- Pine Lake Corn Processors
- Plastic Recycling
- Tri-Rinse
- Winfield United

